

A66 Northern Trans-Pennine Project

Scheme 0102: M6 Junction 40 to Kemplay Bank

TR010062

5.17 Engineering Section Drawings (Plan and Profiles)

APFP Regulations 5(2)(o) and 6(2)

Planning Act 2008

**Infrastructure Planning (Applications: Prescribed Forms and
Procedure) Regulations 2009**

June 2022

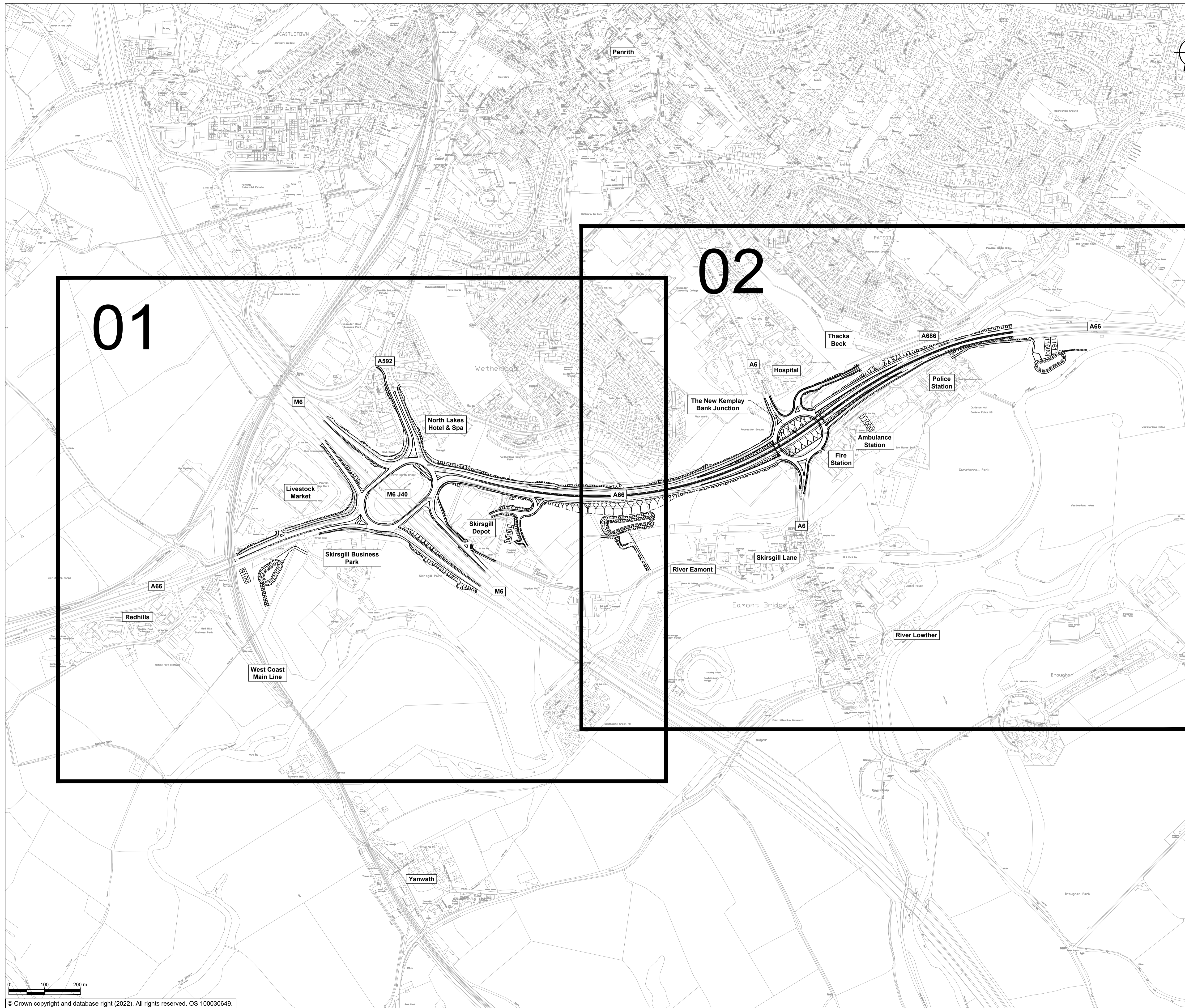

- NOTES**
- ALL DIMENSIONS ARE IN METRES UNLESS NOTED OTHERWISE.
- KEY**
- THE SCHEME (SHOWN FOR ILLUSTRATIVE PURPOSES ONLY)
 - SHEET USED AS PART OF THIS DRAWING SERIES
 - CHAINAGE (MEASURED DISTANCE ALONG THE SCHEME LENGTH)

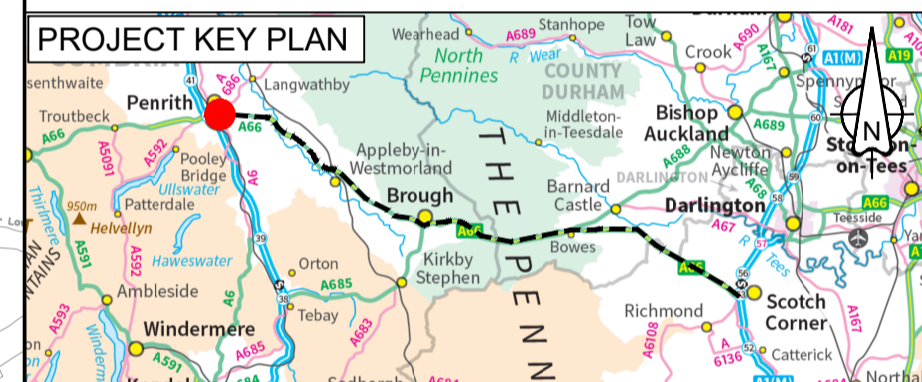

C01	For DCO Submission				
	ESWA	FBLA	ASCR	DKID	SBAG
	06/05/22	06/05/22	06/05/22	09/05/22	10/05/22
Revision	Revision details				
	Created	Checked	Reviewed	Approved	Authorised
	dd/mm/yy	dd/mm/yy	dd/mm/yy	dd/mm/yy	dd/mm/yy

Purpose: DCO APPLICATION

PINS Reference Number: TR010062/APP/5.17

Client: 3 Piccadilly Place, Manchester, M1 3BN

Project Name / Scheme Name: A66 Northern Trans-Pennine Project Scheme 0102
M6 Junction 40 to Kemplay Bank

Drawing Title: Engineering Section Drawings (Plan & Profiles)
Regulation 5(2)(o) and 6(2)
Key Plan

Project Ref. No.	Stage	Scale	@ A1
---	PCF3	1:5000	
		Dimensions	M

Drawing Number	Project	Originator	Volume
HE565627	- AMY	- HAC	-
S0102	-DR-CH-	001000	
Location	Type	Role	Number

Suitability	Suitability Description	Revision
A	Approved for Stage Complete	C01

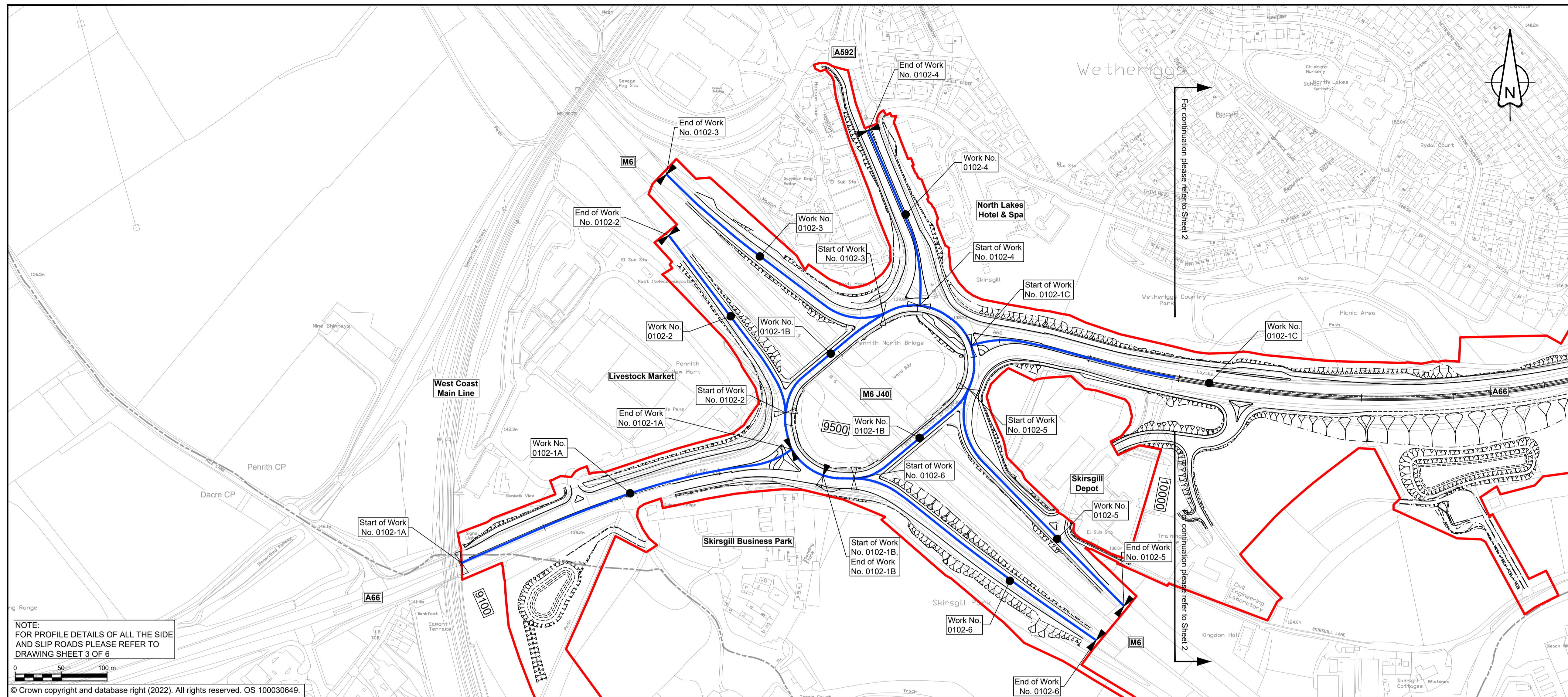

- ### NOTES
- ALL DIMENSIONS ARE IN METRES ABOVE DATUM UNLESS NOTED OTHERWISE.
 - THESE ENGINEERING SECTION DRAWINGS SHOULD BE READ IN CONJUNCTION WITH THE KEY PLAN AND ALONGSIDE OTHER PLANS AND DOCUMENTS IN THE DEVELOPMENT CONSENT ORDER APPLICATION, IN PARTICULAR THE WORKS PLANS AND SCHEDULE 1 (AUTHORISED DEVELOPMENT) TO THE DEVELOPMENT CONSENT ORDER.
 - WORK NO. REFERENCES ARE DETAILED IN SCHEDULE 1 (AUTHORISED DEVELOPMENT) TO THE DEVELOPMENT CONSENT ORDER.
 - THE DESIGN SHOWN ON THESE ENGINEERING SECTION DRAWINGS IS ILLUSTRATIVE AND WILL BE SUBJECT TO DETAILED DESIGN DEVELOPMENT; ANY CHANGES WILL BE LIMITED TO BEING WITHIN THE ORDER LIMITS AND ANY OTHER CONSTRAINTS INCLUDED IN THE DEVELOPMENT CONSENT ORDER.

- ### KEY
- THE SCHEME (SHOWN FOR ILLUSTRATIVE PURPOSES ONLY)
 - LONGITUDINAL SECTION LINE
 - PROPOSED LEVEL
 - EXISTING LEVEL
 - ORDER LIMITS
 - PARISH BOUNDARY
 - ROAD NAMES
 - CHAINAGE (MEASURED DISTANCE ALONG THE SCHEME LENGTH)
 - GRADIENT
 - LENGTH
 - RADIUS

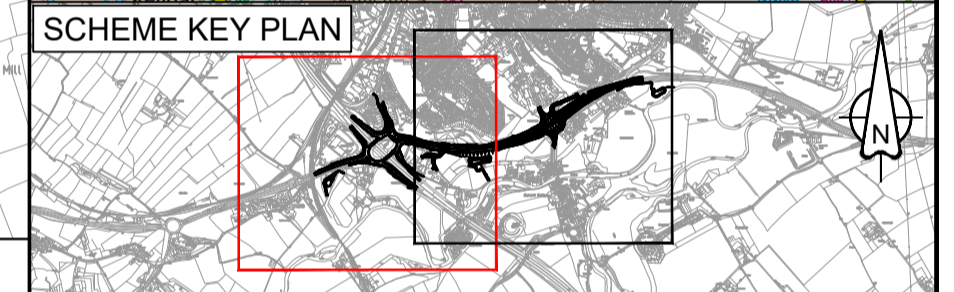
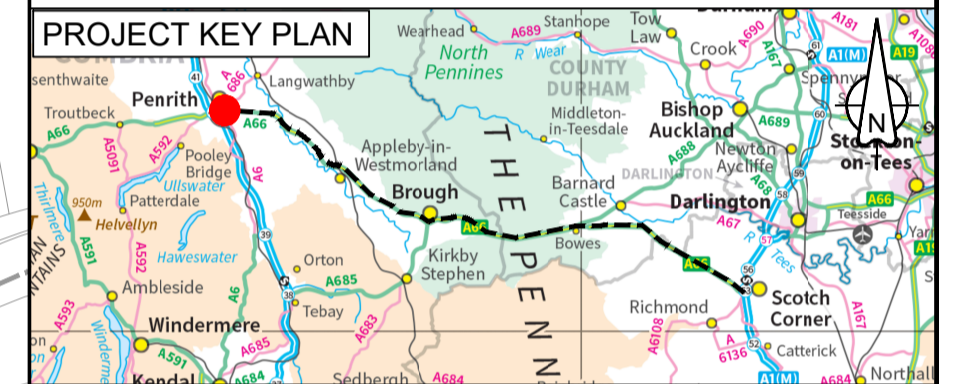

NOTE:
FOR PROFILE DETAILS OF ALL THE SIDE AND SLIP ROADS PLEASE REFER TO DRAWING SHEET 3 OF 6

0 50 100 m

© Crown copyright and database right (2022). All rights reserved. OS 100030649.

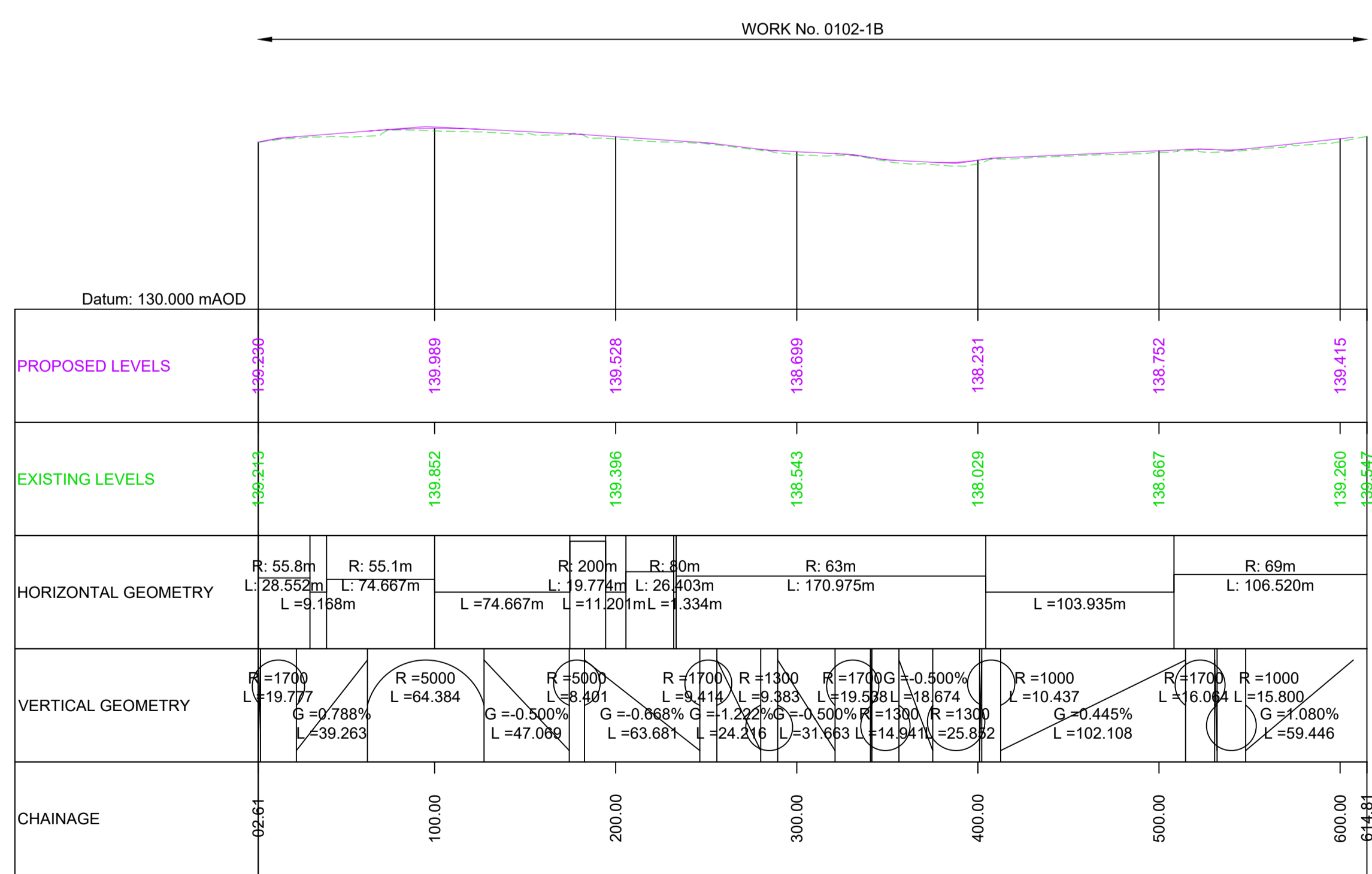

MAINLINE LONGITUDINAL SECTION - CH 0 TO CH 614.61

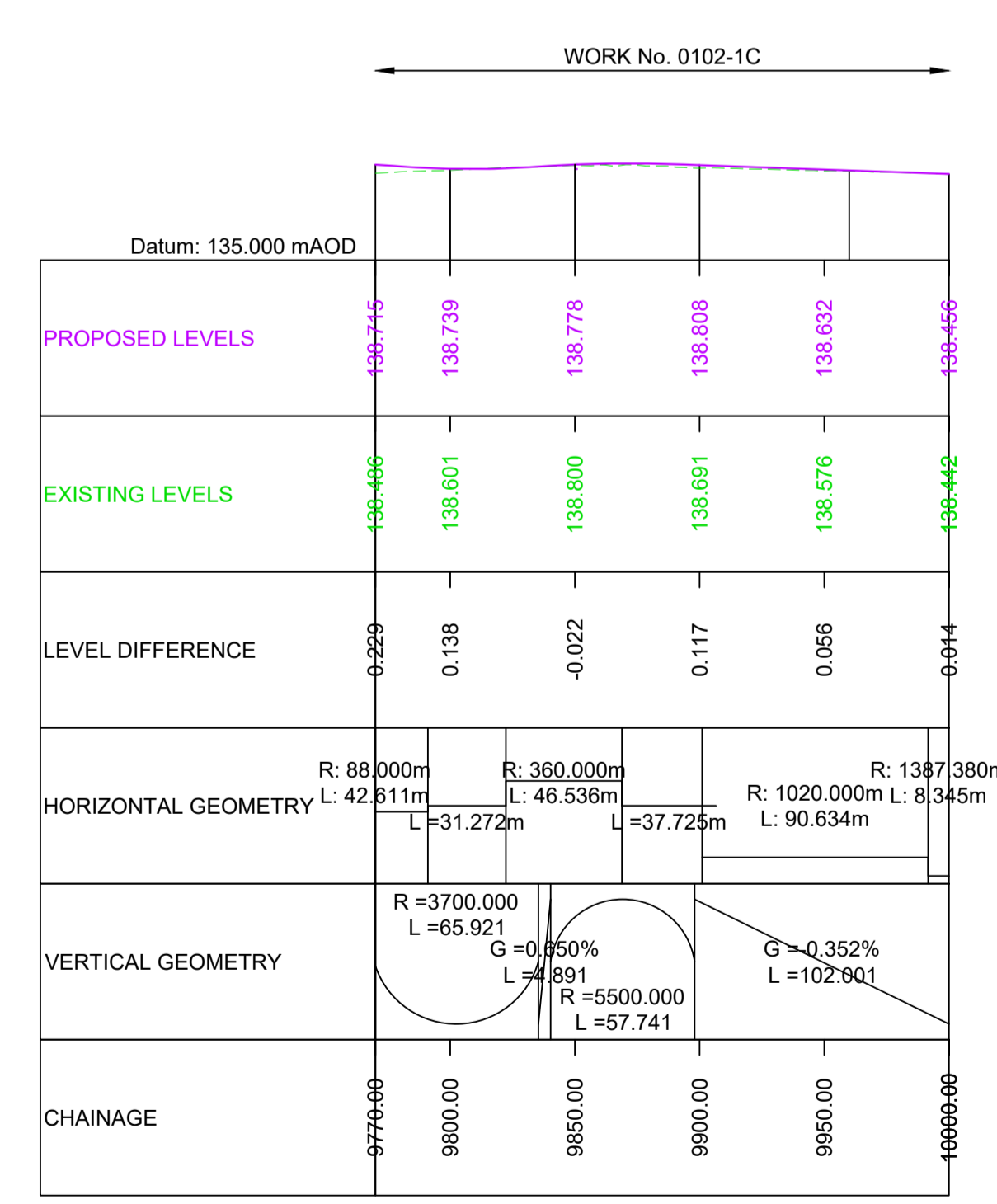

MAINLINE LONGITUDINAL SECTION - CH 9770 TO CH 10000

C01	For DCO Submission				
	ESWA	FBLA	ASCR	SBAG	SBAG
	31/05/22	31/05/22	06/06/22	06/06/22	06/06/22
Revision	Revision details				
	Created	Checked	Reviewed	Approved	Authorised
	dd/mm/yy	dd/mm/yy	dd/mm/yy	dd/mm/yy	dd/mm/yy

Purpose: DCO APPLICATION

PINS Reference Number: TR010062/APP/5.17

Client: 3 Piccadilly Place, Manchester, M1 3BN

Project Name / Scheme Name: A66 Northern Trans-Pennine Project Scheme 0102 M6 Junction 40 to Kemplay Bank

Drawing Title: Engineering Section Drawings (Plan and Profiles) Regulation 5(2)(o) & 6(2) Sheet 1 of 6

Project Ref. No.	Stage	Scale	@ A1
---	PCF3	1:2500	
		Dimensions	M

Drawing Number: HE565627 - AMY - HAC - S0102 -DR-CH- 001001

Location: | Type | Role | Number

Suitability	Suitability Description	Revision
A	Approved for Stage Complete	C01

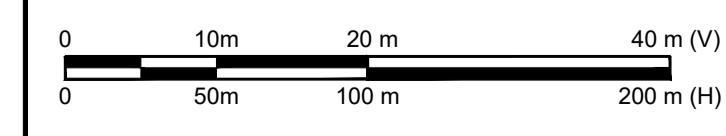

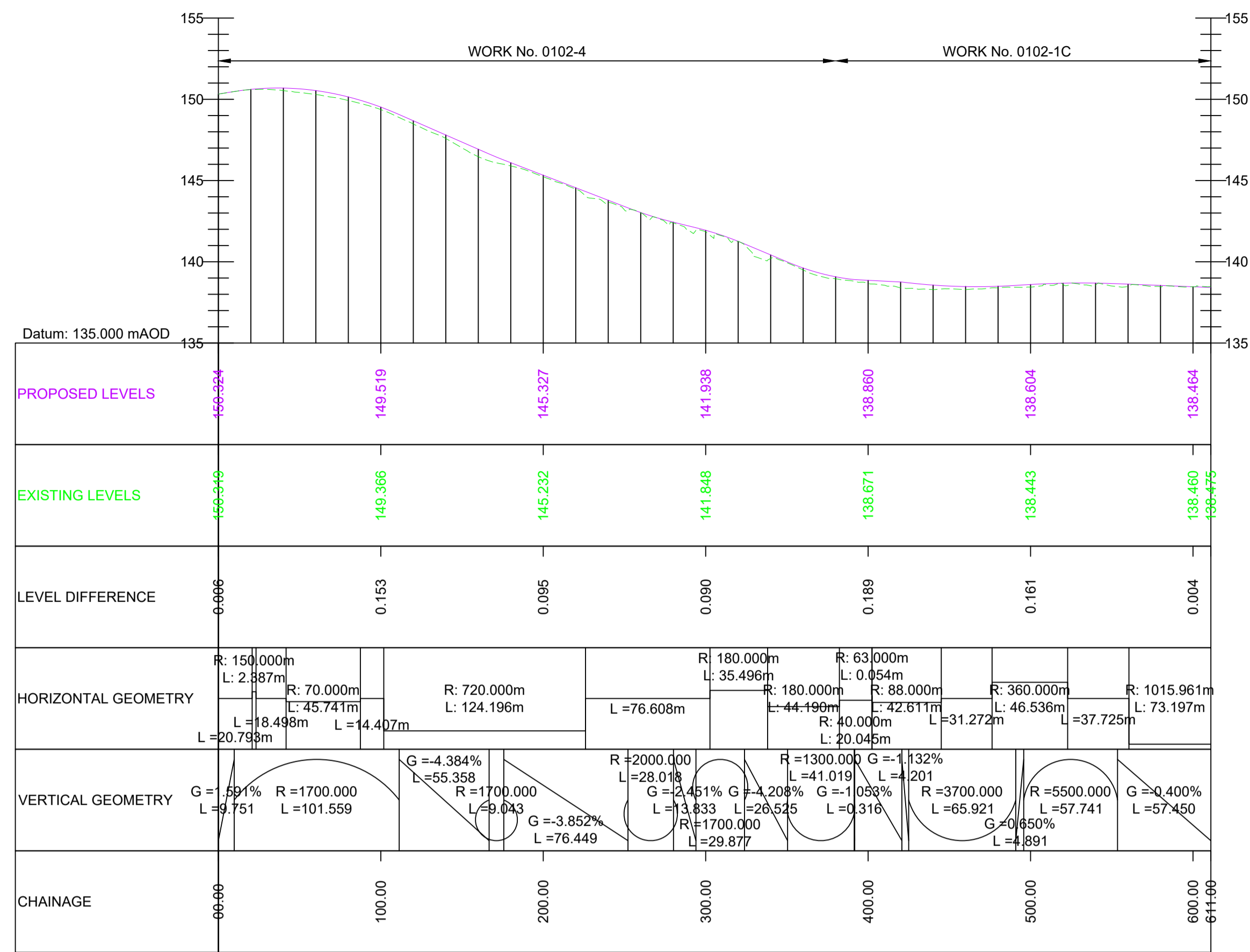

Scale H 1:2500; V 1:1250

A592 SOUTHBOUND TO A66 EASTBOUND

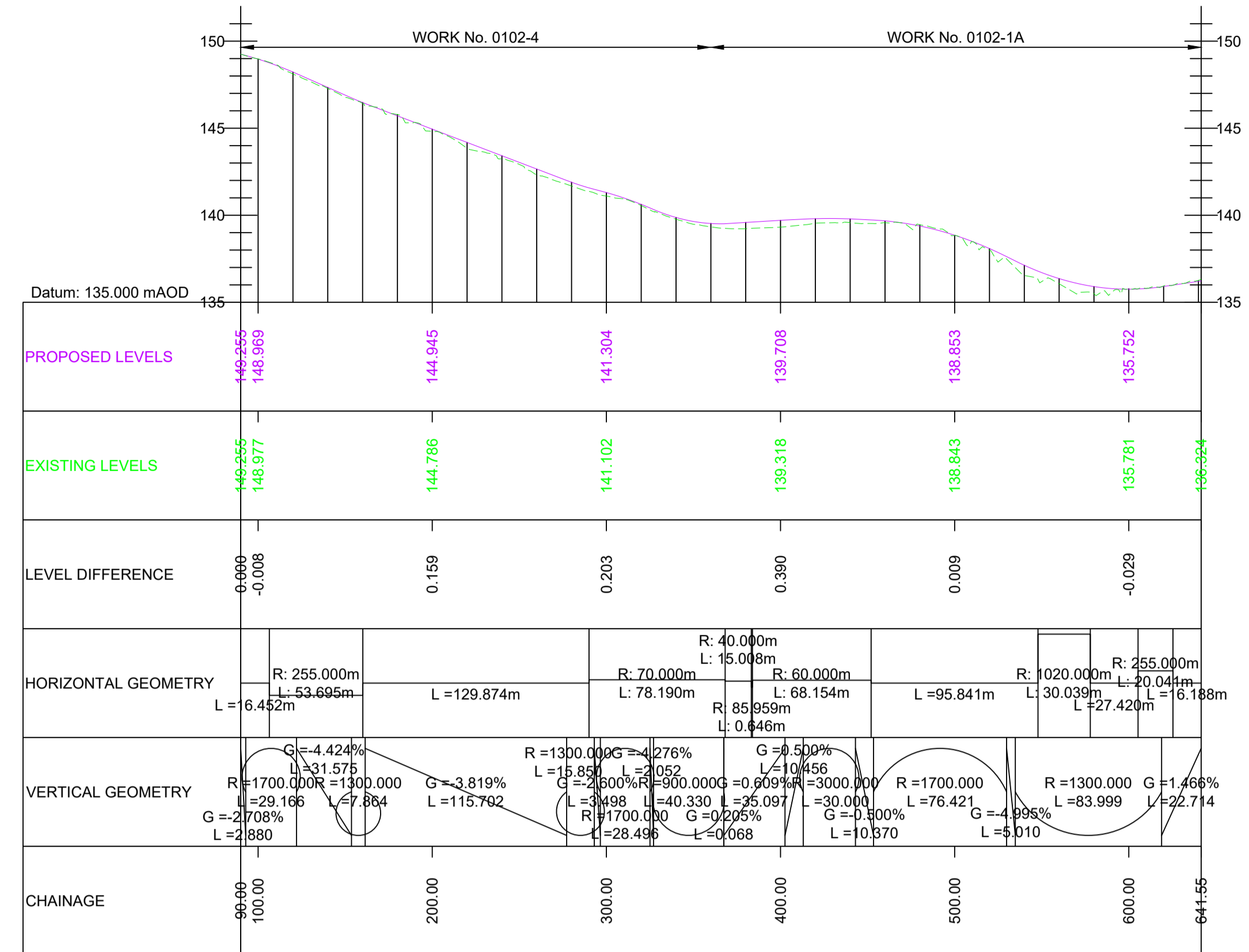

Scale H 1:2500; V 1:1250

A592 NORTHBOUND TO M6 SOUTHBOUND DIVERGE

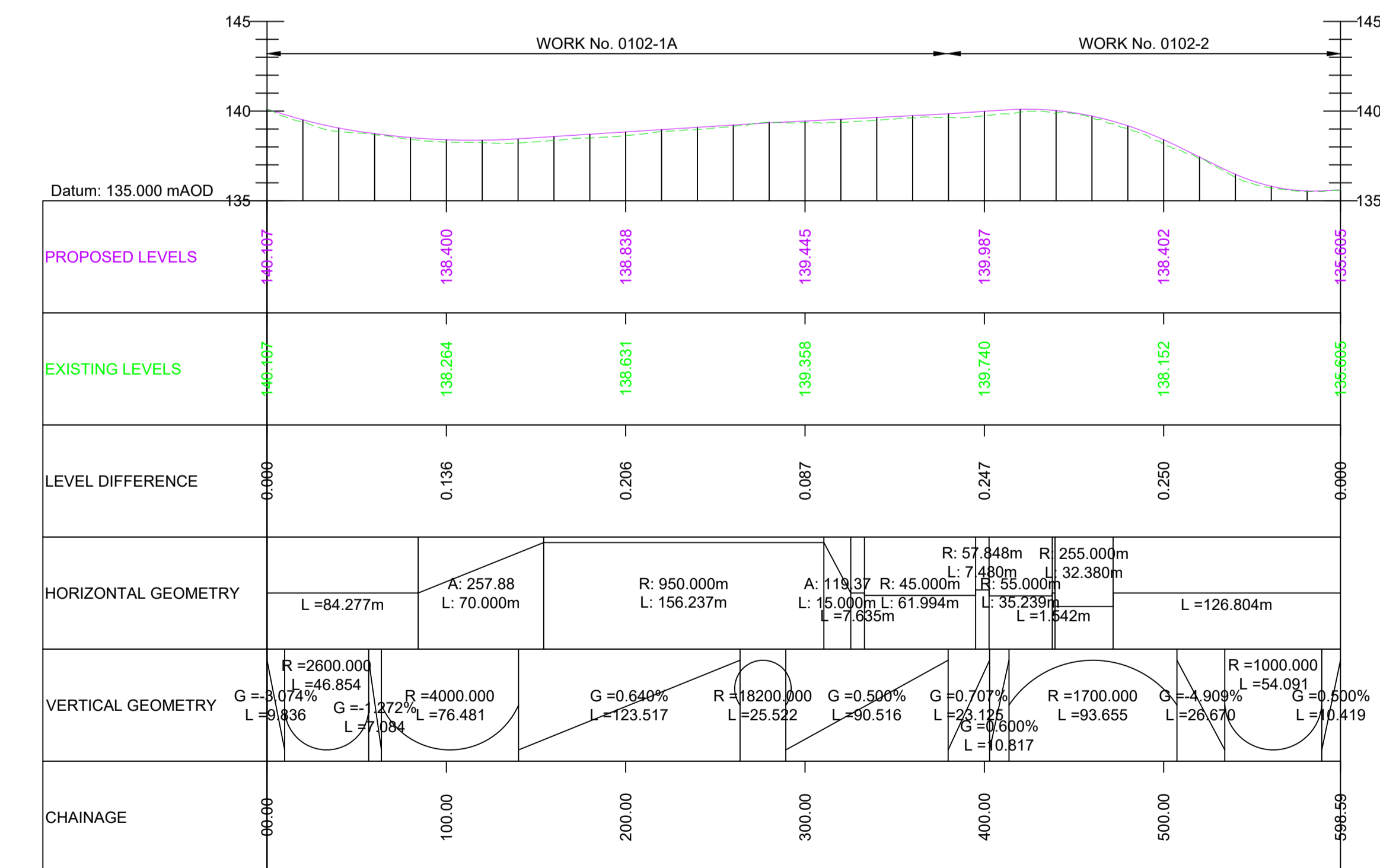

Scale H 1:2500; V 1:1250

A66 NORTHBOUND TO M6 NORTHBOUND MERGE

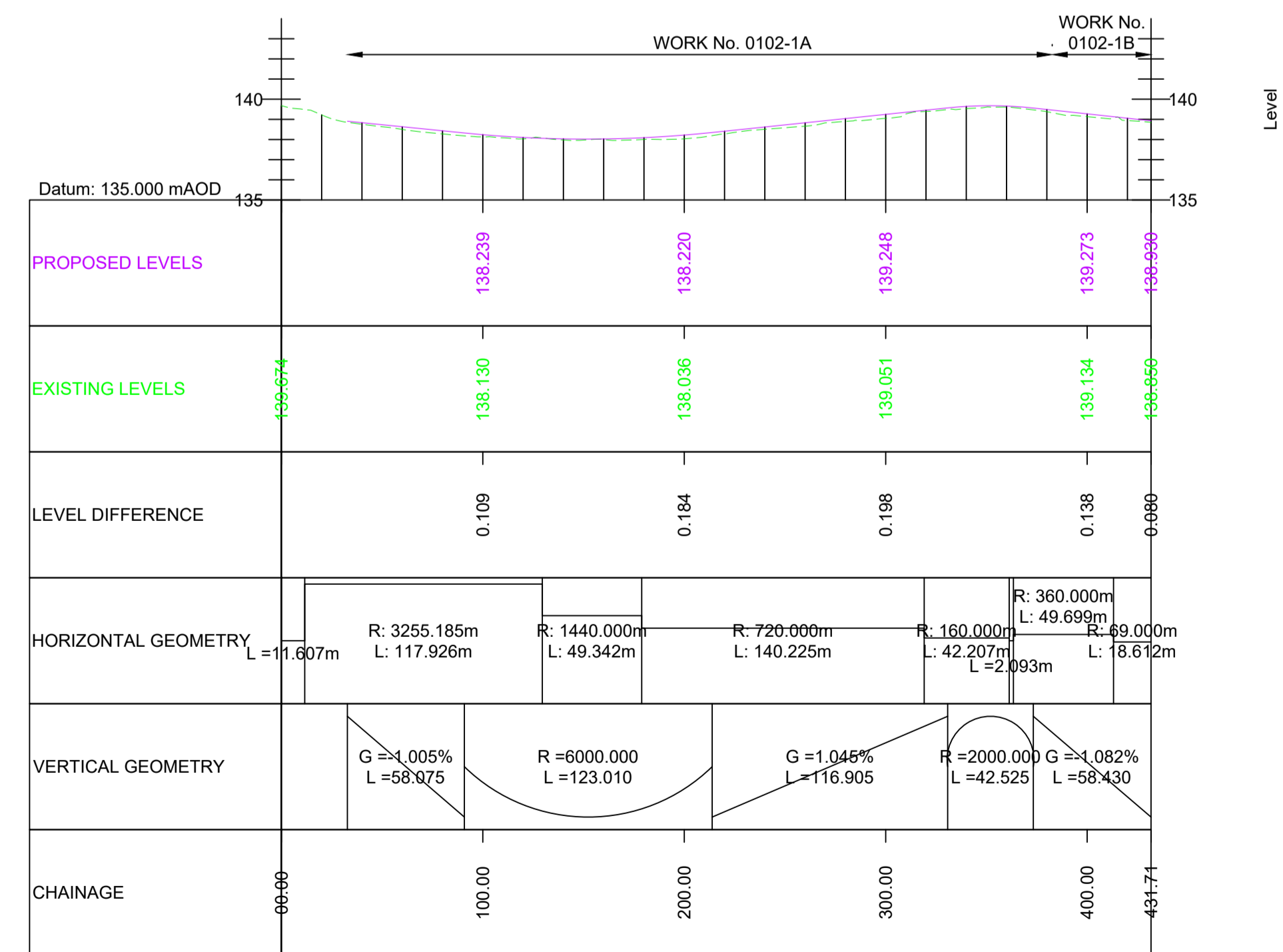

Scale H 1:2500; V 1:1250

A66 NORTHBOUND TO M6 NORTHBOUND DIVERGE

NOTES

1. ALL DIMENSIONS ARE IN METRES ABOVE DATUM UNLESS NOTED OTHERWISE.
2. THESE ENGINEERING SECTION DRAWINGS SHOULD BE READ IN CONJUNCTION WITH THE KEY PLAN AND ALONGSIDE OTHER PLANS AND DOCUMENTS IN THE DEVELOPMENT CONSENT ORDER APPLICATION. IN PARTICULAR THE WORKS PLANS AND SCHEDULE 1 (AUTHORISED DEVELOPMENT) TO THE DEVELOPMENT CONSENT ORDER.
3. WORK No. REFERENCES ARE DETAILED IN SCHEDULE 1 (AUTHORISED DEVELOPMENT) TO THE DEVELOPMENT CONSENT ORDER.
4. THE DESIGN SHOWN ON THESE ENGINEERING SECTION DRAWINGS IS ILLUSTRATIVE AND WILL BE SUBJECT TO DETAILED DESIGN DEVELOPMENT; ANY CHANGES WILL BE LIMITED TO BEING WITHIN THE ORDER LIMITS AND ANY OTHER CONSTRAINTS INCLUDED IN THE DEVELOPMENT CONSENT ORDER.

KEY

- PROPOSED LEVEL
- - - EXISTING LEVEL
- G = Gradient
- L = Length
- R = Radius

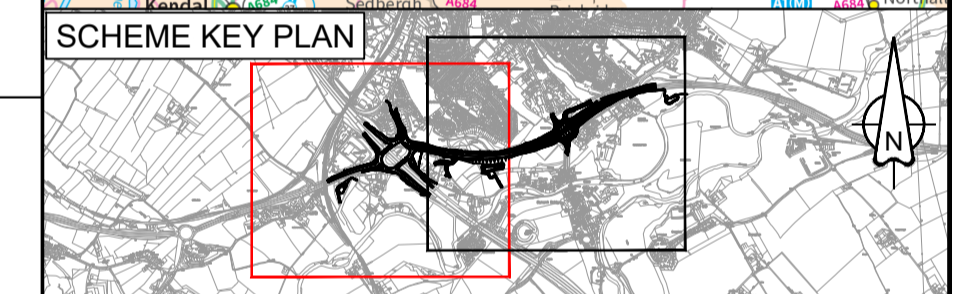
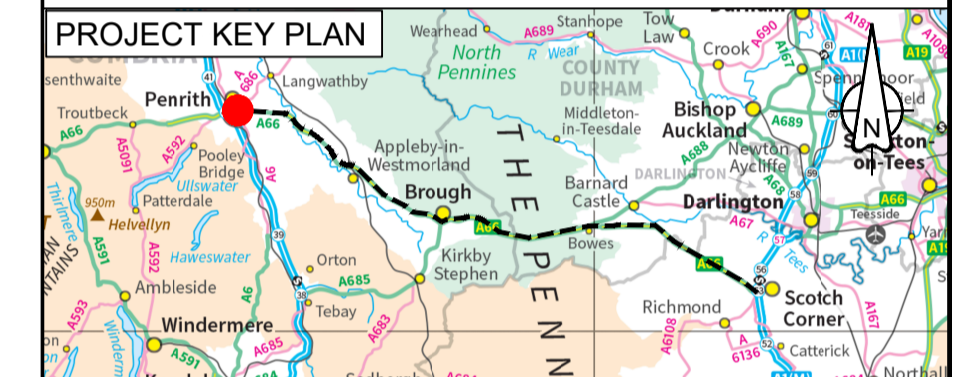

For DCO Submission					
C01	ESWA	FBLA	ASCR	SBAG	SBAG
	31/05/22	31/05/22	06/06/22	06/06/22	06/06/22
Revision details					
Revision	Created	Checked	Reviewed	Approved	Authorised
	dd/mm/yy	dd/mm/yy	dd/mm/yy	dd/mm/yy	dd/mm/yy

Purpose	DCO APPLICATION
PINS Reference Number	TR010062/APP/5.17

Client	3 Piccadilly Place Manchester M1 3BN	
--------	--------------------------------------------	--

Project Name / Scheme Name
**A66 Northern Trans-Pennine Project
 Scheme 0102
 M6 Junction 40 to Kemplay Bank**

Drawing Title
**Engineering Section Drawings
 (Plan and Profiles)
 Regulation 5(2)(o) & 6(2)
 Sheet 3 of 6**

Project Ref. No.	Stage	Scale:	@ A1
---	PCF3	1:2500	
		Dimensions:	M

Drawing Number	Project	Originator	Volume
HE565627	- AMY	- HAC	-
S0102	-DR-CH-	001002	
Location	Type	Role	Number

Suitability	Suitability Description	Revision
A	Approved for Stage Complete	C01

NOTE:
 FOR PLAN VIEW OF J40 PLEASE
 REFER TO DRAWING SHEET 1 OF 6

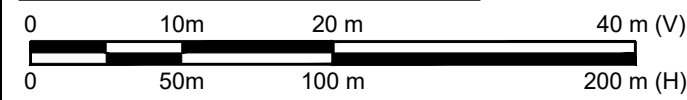

NOTES

1. ALL DIMENSIONS ARE IN METRES ABOVE DATUM UNLESS NOTED OTHERWISE.
2. THESE ENGINEERING SECTION DRAWINGS SHOULD BE READ IN CONJUNCTION WITH THE KEY PLAN AND ALONGSIDE OTHER PLANS AND DOCUMENTS IN THE DEVELOPMENT CONSENT ORDER APPLICATION. IN PARTICULAR THE WORKS PLANS AND SCHEDULE 1 (AUTHORISED DEVELOPMENT) TO THE DEVELOPMENT CONSENT ORDER.
3. WORK No. REFERENCES ARE DETAILED IN SCHEDULE 1 (AUTHORISED DEVELOPMENT) TO THE DEVELOPMENT CONSENT ORDER.
4. THE DESIGN SHOWN ON THESE ENGINEERING SECTION DRAWINGS IS ILLUSTRATIVE AND WILL BE SUBJECT TO DETAILED DESIGN DEVELOPMENT; ANY CHANGES WILL BE LIMITED TO BEING WITHIN THE ORDER LIMITS AND ANY OTHER CONSTRAINTS INCLUDED IN THE DEVELOPMENT CONSENT ORDER.

KEY

- PROPOSED LEVEL
- - - EXISTING LEVEL
- G = Gradient
- L = Length
- R = Radius

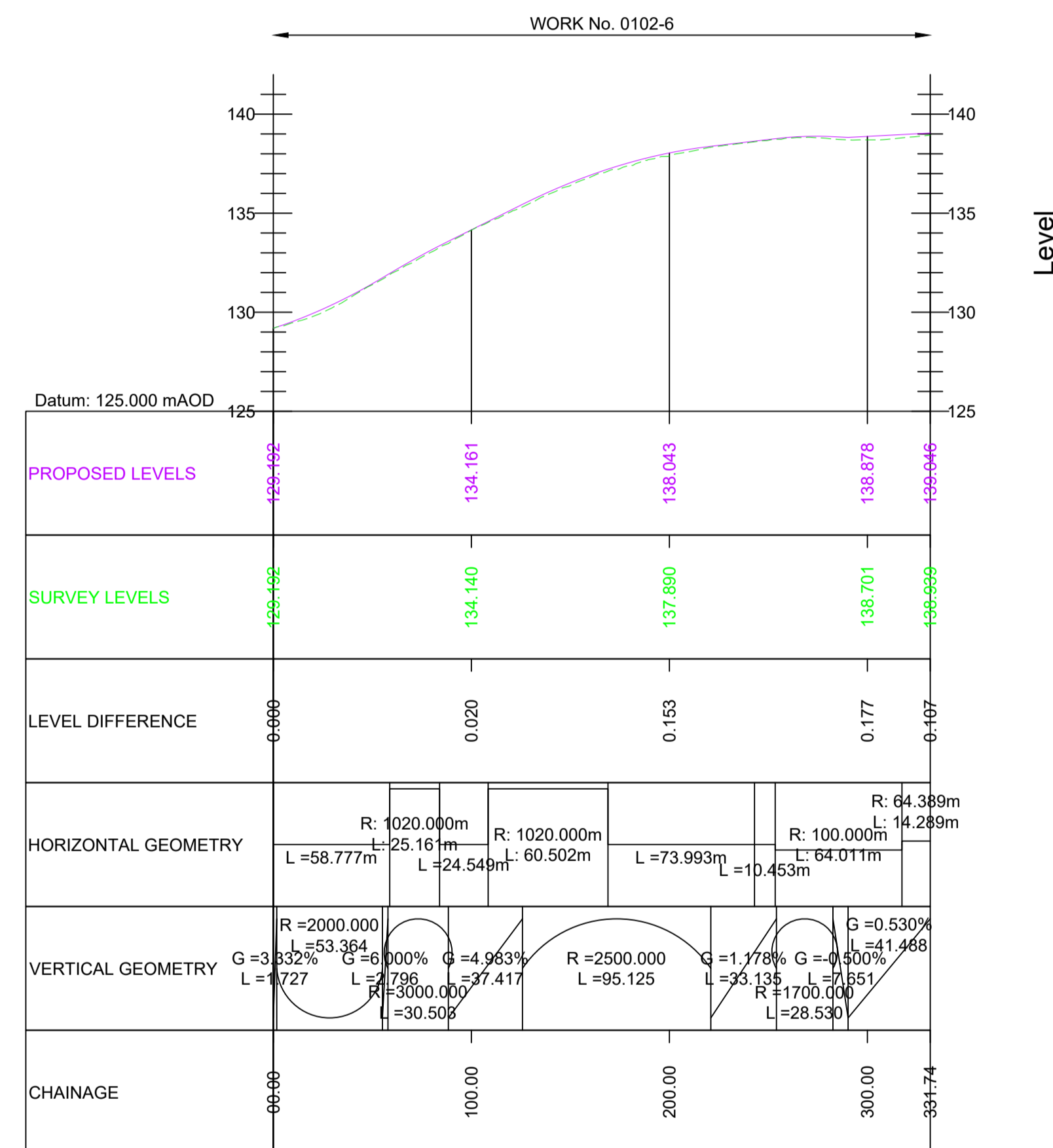

Scale H 1:2500; V 1:1250

M6 NORTHBOUND DIVERGE TO A66 WESTBOUND

NOTE:
FOR PLAN VIEW OF J40
PLEASE REFER TO DRAWING
SHEET 1 OF 6

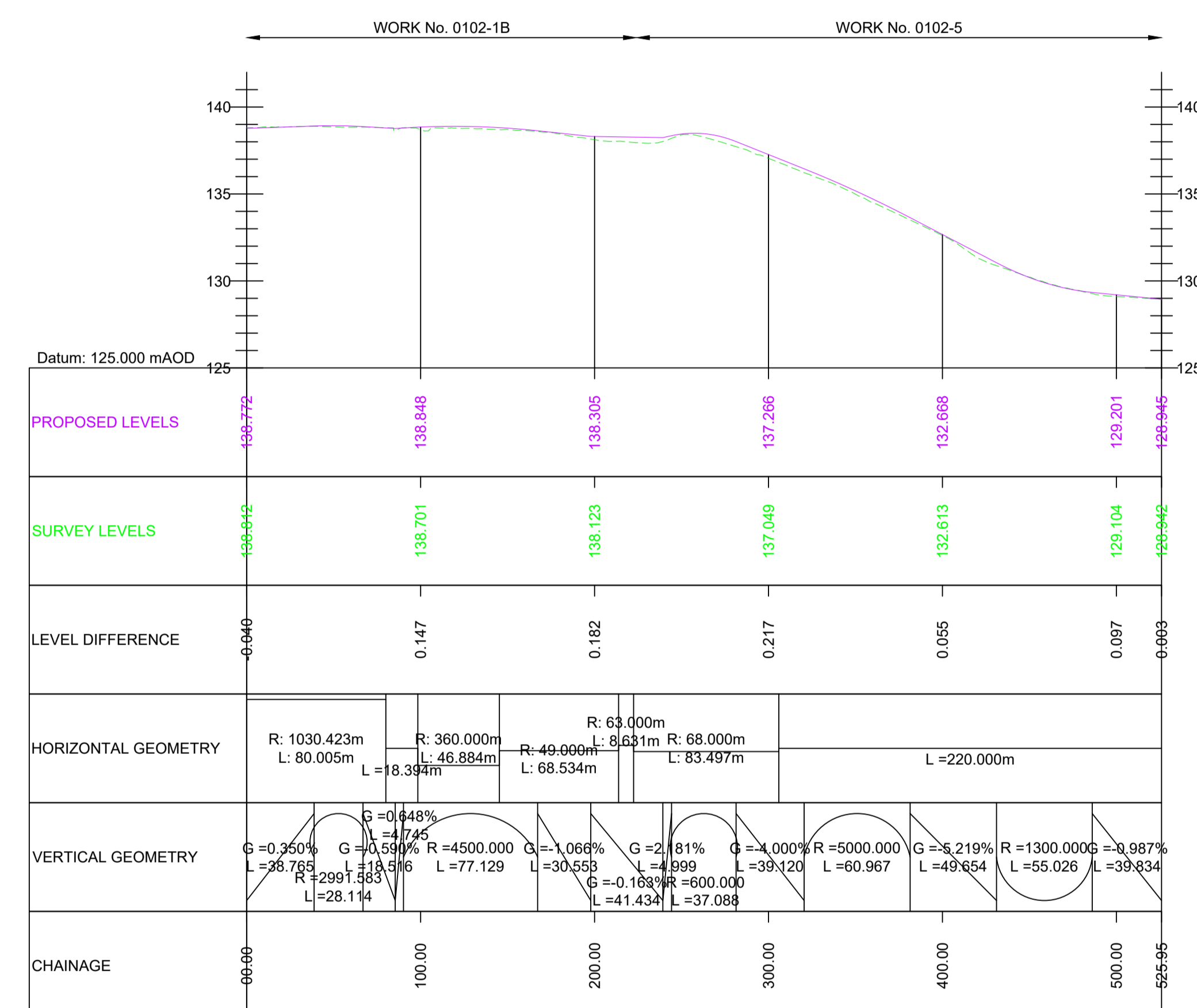
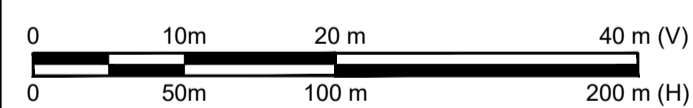

Scale H 1:2500; V 1:1250

A66 EASTBOUND TO M6 SOUTHBOUND MERGE

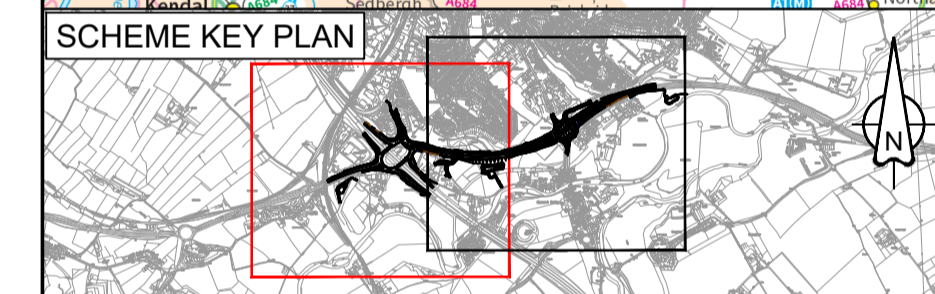

For DCO Submission				
ESWA	FBLA	ASCR	SBAG	SBAG
31/05/22	31/05/22	06/06/22	06/06/22	06/06/22

Revision details				
Created	Checked	Reviewed	Approved	Authorised
dd/mm/yy	dd/mm/yy	dd/mm/yy	dd/mm/yy	dd/mm/yy

Purpose: DCO APPLICATION

PINS Reference Number: TR010062/APP/5.17

Client: 3 Piccadilly Place, Manchester, M1 3BN

Project Name / Scheme Name: A66 Northern Trans-Pennine Project Scheme 0102 M6 Junction 40 to Kemplay Bank

Drawing Title: Engineering Section Drawings (Plan and Profiles) Regulation 5(2)(o) & 6(2) Sheet 4 of 6

Project Ref. No. ---	Stage PCF3	Scale: 1:2500	@ A1
		Dimensions: M	

Drawing Number	Project	Originator	Volume
HE565627	- AMY	- HAC	-
S0102	-DR-CH-	001003	
Location	Type	Role	Number

Suitability	Suitability Description	Revision
A	Approved for Stage Complete	C01

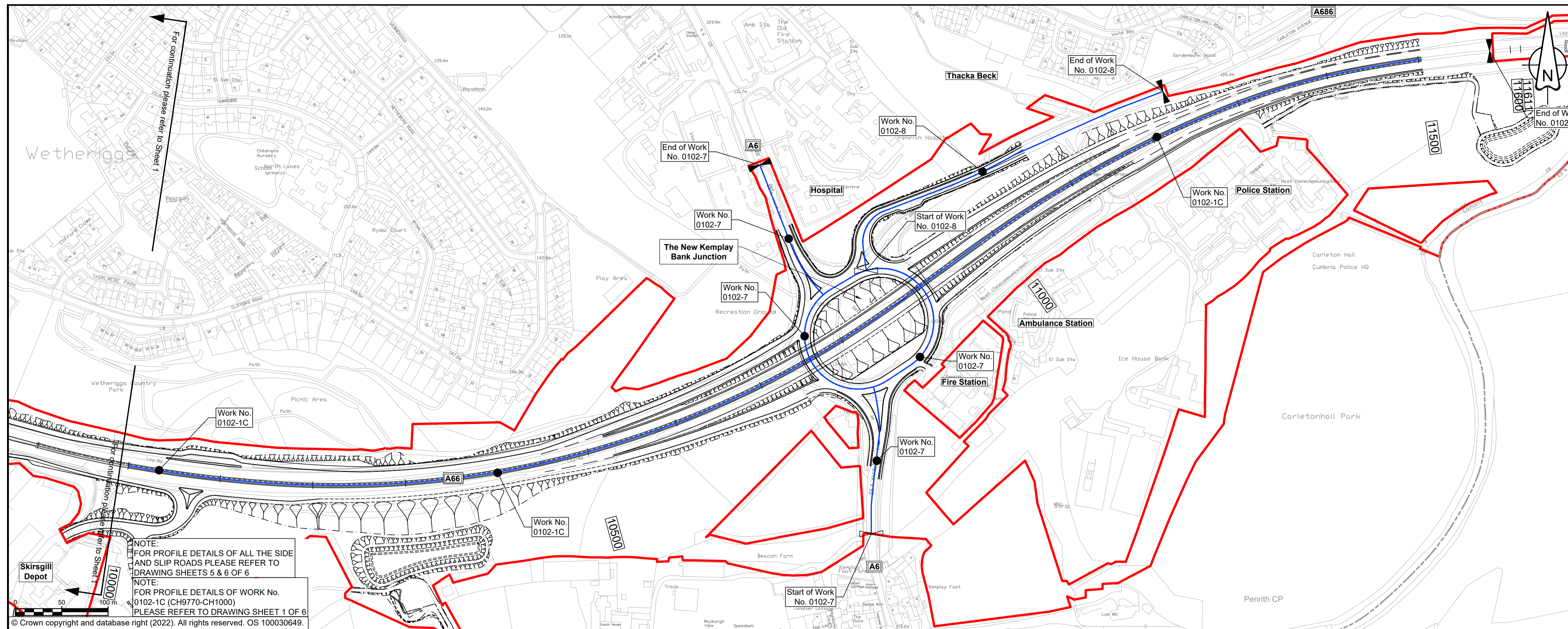

- ### NOTES
- ALL DIMENSIONS ARE IN METRES ABOVE DATUM UNLESS NOTED OTHERWISE.
 - THESE ENGINEERING SECTION DRAWINGS SHOULD BE READ IN CONJUNCTION WITH THE KEY PLAN AND ALONGSIDE OTHER PLANS AND DOCUMENTS IN THE DEVELOPMENT CONSENT ORDER APPLICATION, IN PARTICULAR THE WORKS PLANS AND SCHEDULE 1 (AUTHORISED DEVELOPMENT) TO THE DEVELOPMENT CONSENT ORDER.
 - WORK NO. REFERENCES ARE DETAILED IN SCHEDULE 1 (AUTHORISED DEVELOPMENT) TO THE DEVELOPMENT CONSENT ORDER.
 - THE DESIGN SHOWN ON THESE ENGINEERING SECTION DRAWINGS IS ILLUSTRATIVE AND WILL BE SUBJECT TO DETAILED DESIGN DEVELOPMENT; ANY CHANGES WILL BE LIMITED TO BEING WITHIN THE ORDER LIMITS AND ANY OTHER CONSTRAINTS INCLUDED IN THE DEVELOPMENT CONSENT ORDER.
- ### KEY
- THE SCHEME (SHOWN FOR ILLUSTRATIVE PURPOSES ONLY)
 - LONGITUDINAL SECTION LINE
 - PROPOSED LEVEL
 - EXISTING LEVEL
 - ORDER LIMITS
 - PARISH BOUNDARY
 - ROAD NAMES
 - CHAINAGE (MEASURED DISTANCE ALONG THE SCHEME LENGTH)
 - GRADIENT
 - LENGTH
 - RADIUS

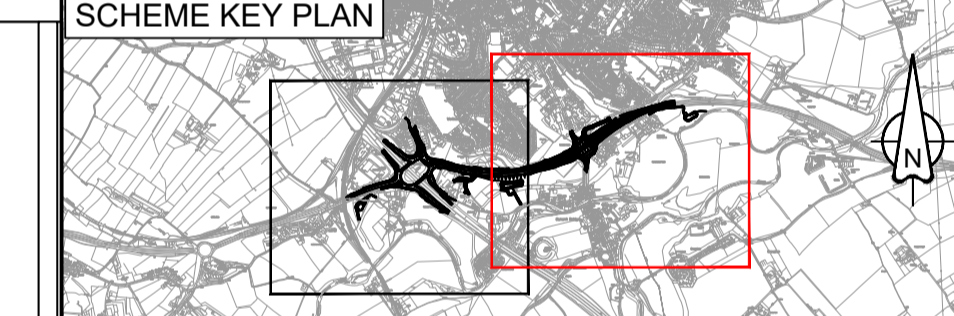
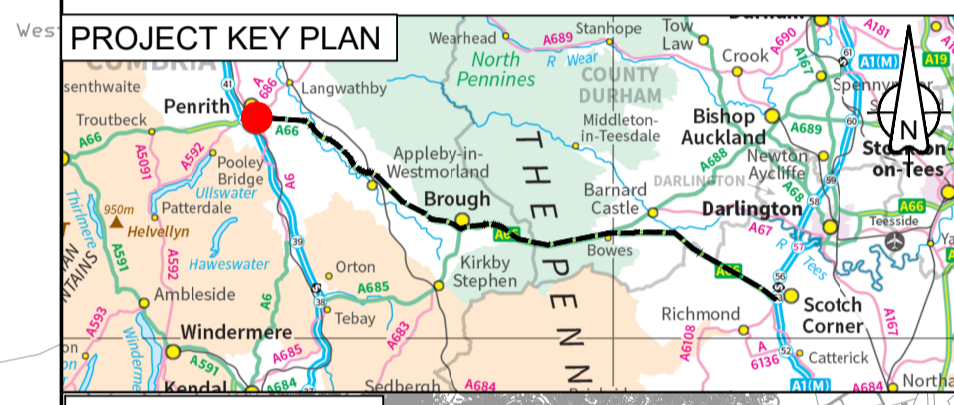

C01	For DCO Submission				
	ESWA	FBLA	ASCR	SBAG	SBAG
	31/05/22	31/05/22	06/06/22	06/06/22	06/06/22
Revision details					
Revision	Created	Checked	Reviewed	Approved	Authorised
	dd/mm/yy	dd/mm/yy	dd/mm/yy	dd/mm/yy	dd/mm/yy

Purpose: DCO APPLICATION

PINS Reference Number: TR010062/APP/5.17

Client: 3 Piccadilly Place, Manchester, M1 3BN

Project Name / Scheme Name: A66 Northern Trans-Pennine Project Scheme 0102 M6 Junction 40 to Kemplay Bank

Drawing Title: Engineering Section Drawings (Plan and Profiles) Regulation 5(2)(o) & 6(2) Sheet 2 of 6

Project Ref. No.	Stage	Scale	@ A1
---	PCF3	1:2500	
		Dimensions	M
Drawing Number			
Project	Originator	Volume	
HE565627	AMY	HAC	
S0102		DR-CH	101001
Location		Type	Role
			Number

Suitability	Suitability Description	Revision
A	Approved for Stage Complete	C01

FOR CONTINUATION OF WORK No. 0102-1C PLEASE REFER TO SHEET 1 OF 6

WORK No. 0102-1C

Datum: 118.000 mAOD

PROPOSED LEVELS	136.466	136.106	137.756	137.406	137.056	136.394	134.069	129.963	125.834	125.718	128.284	125.168	128.254	125.522	121.721	119.117					
EXISTING LEVELS	136.443	137.723	137.386	137.130	136.785	136.767	135.930	135.944	136.167	133.512	131.927	127.322	126.237	123.729	121.243	119.104					
LEVEL DIFFERENCE	0.014	0.383	0.371	0.276	0.271	-0.373	-1.862	-5.991	-10.332	-7.795	-3.662	1.846	2.018	1.793	0.478	0.013					
HORIZONTAL GEOMETRY	R: 1387.376m L: 150.296m		A: 351.20 L: 32.020m		R: 1020.000m L: 626.173m			A: 351.20 L: 120.922m		A: 351.20 L: 102.784m		R: 1200.000m L: 245.343m		A: 330.00 L: 60.500m		R: 720.000m L: 65.628m		A: 285.05 L: 60.500m			
VERTICAL GEOMETRY	G = -0.350% L = 441.375				R = 5500.000 L = 241.337			G = 4.738% L = 64.900		R = 2215.422 L = 175.118		G = 3.167% L = 2.840		R = 5500.000 L = 394.661		G = 4.009% L = 30.921		R = 7000.000 L = 139.364		G = -2.018% L = 20.017	
CHAINAGE	10000.00	10100.00	10200.00	10300.00	10400.00	10500.00	10600.00	10700.00	10800.00	10900.00	11000.00	11100.00	11200.00	11300.00	11400.00	11500.00					



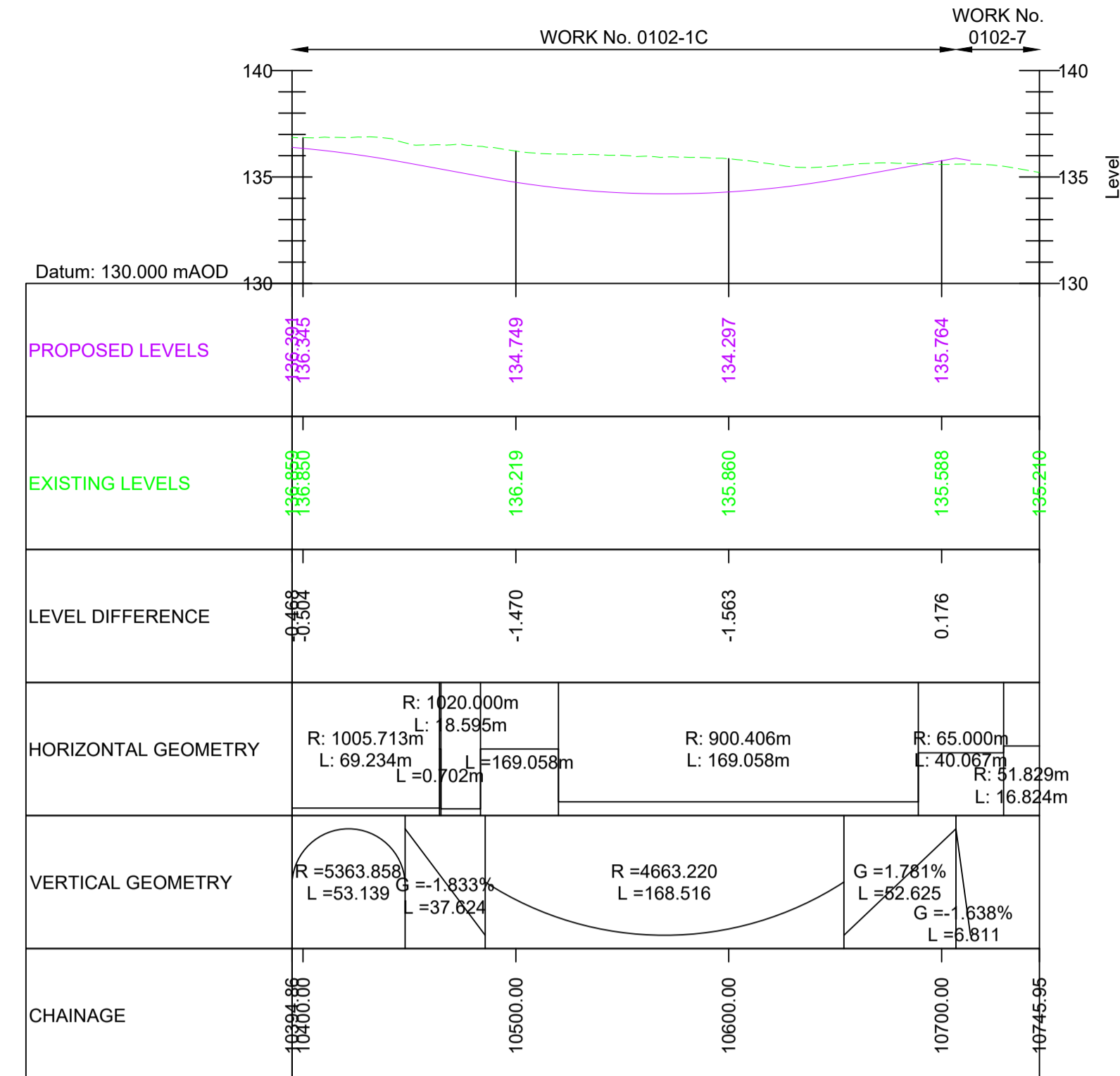

A66 NORTHBOUND DIVERGE TO KEMPLAY BANK JUNCTION

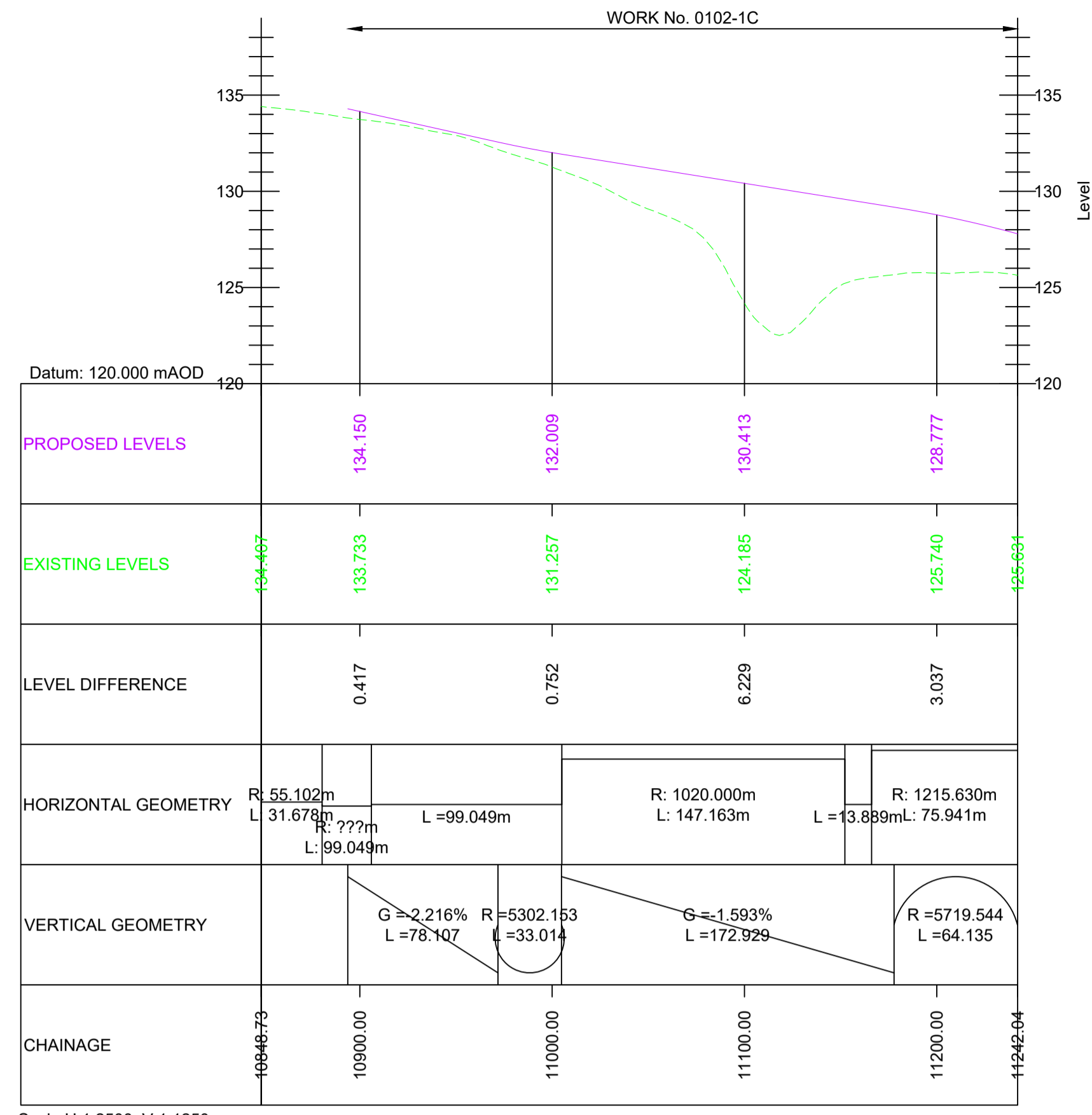

KEMPLAY BANK JUNCTION TO A66 SOUTHBOUND MERGE

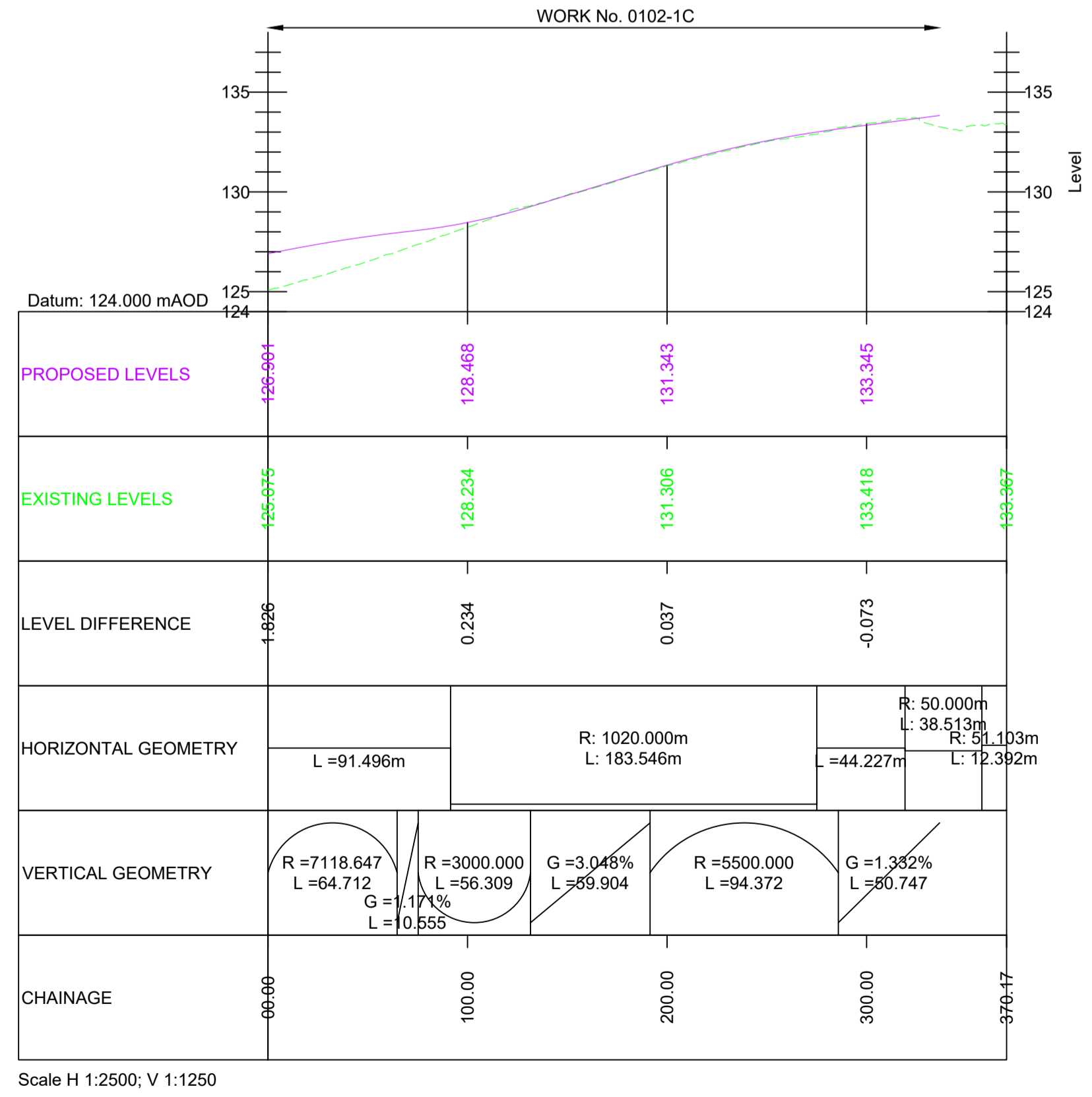

A66 SOUTHBOUND DIVERGE TO KEMPLAY BANK JUNCTION

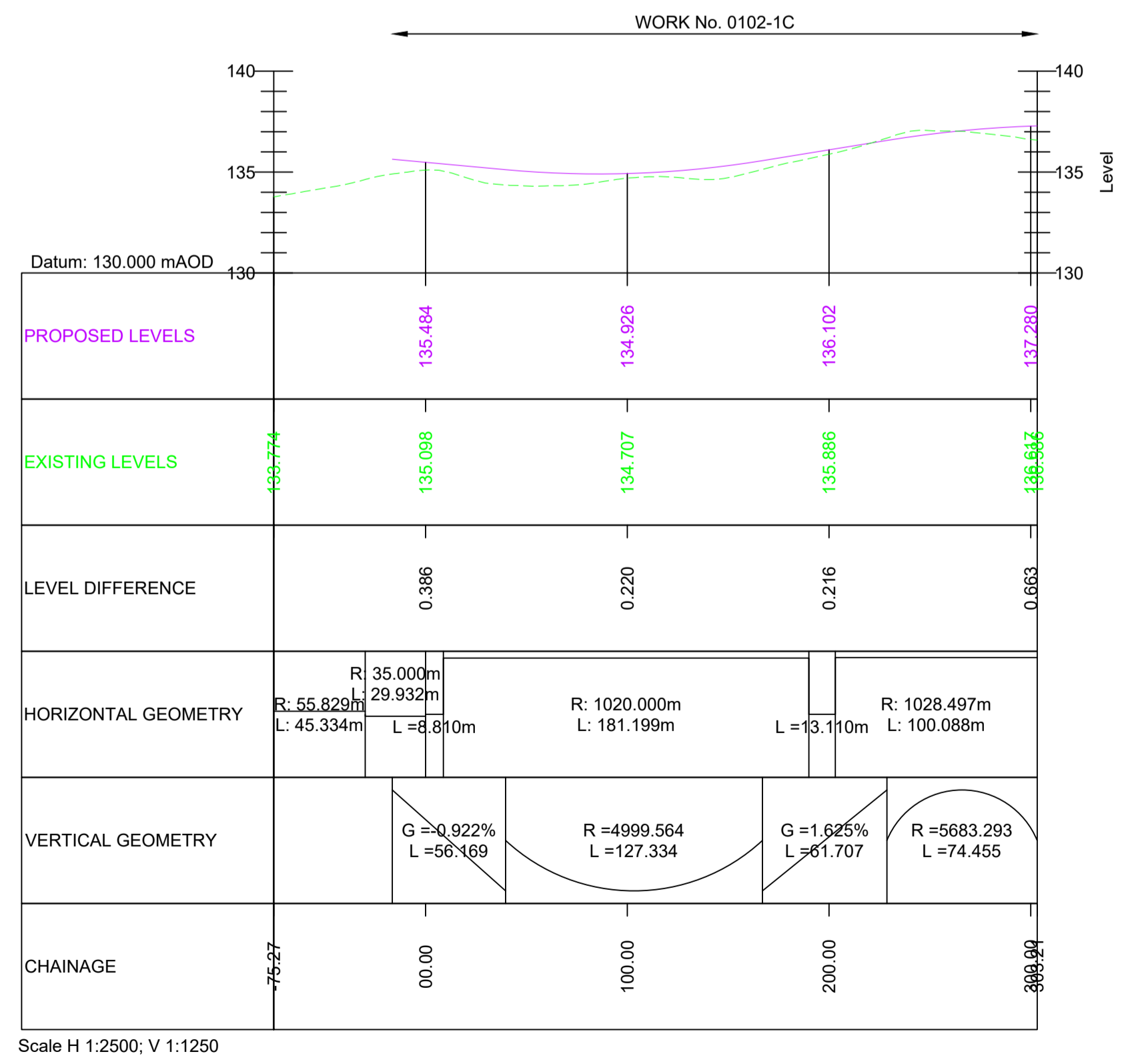

KEMPLAY BANK JUNCTION TO A66 SOUTHBOUND MERGE

NOTES

1. ALL DIMENSIONS ARE IN METRES ABOVE DATUM UNLESS NOTED OTHERWISE.
2. THESE ENGINEERING SECTION DRAWINGS SHOULD BE READ IN CONJUNCTION WITH THE KEY PLAN AND ALONGSIDE OTHER PLANS AND DOCUMENTS IN THE DEVELOPMENT CONSENT ORDER APPLICATION. IN PARTICULAR THE WORKS PLANS AND SCHEDULE 1 (AUTHORISED DEVELOPMENT) TO THE DEVELOPMENT CONSENT ORDER.
3. WORK No. REFERENCES ARE DETAILED IN SCHEDULE 1 (AUTHORISED DEVELOPMENT) TO THE DEVELOPMENT CONSENT ORDER.
4. THE DESIGN SHOWN ON THESE ENGINEERING SECTION DRAWINGS IS ILLUSTRATIVE AND WILL BE SUBJECT TO DETAILED DESIGN DEVELOPMENT. ANY CHANGES WILL BE LIMITED TO BEING WITHIN THE ORDER LIMITS AND ANY OTHER CONSTRAINTS INCLUDED IN THE DEVELOPMENT CONSENT ORDER.

KEY

- PROPOSED LEVEL
- - - EXISTING LEVEL
- G = Gradient
- L = Length
- R = Radius

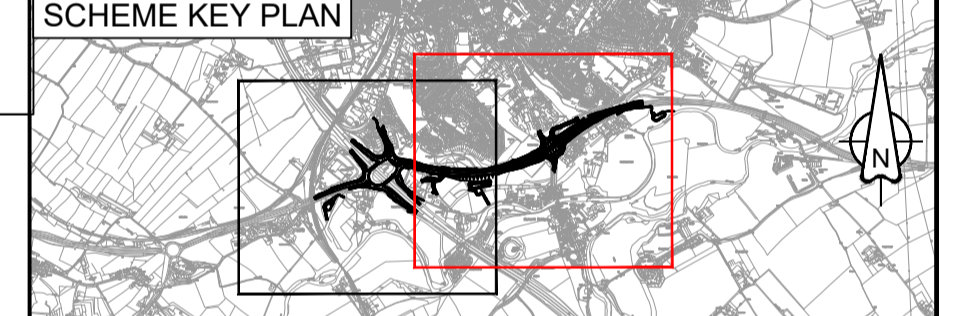
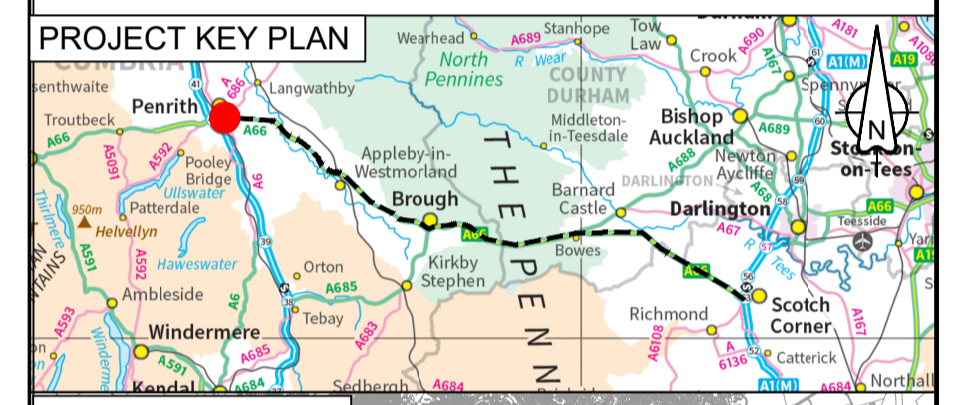

C01	For DCO Submission				
	ESWA	FBLA	ASCR	SBAG	SBAG
	31/05/22	31/05/22	06/06/22	06/06/22	06/06/22
Revision	Revision details				
	Created	Checked	Reviewed	Approved	Authorised
	dd/mm/yy	dd/mm/yy	dd/mm/yy	dd/mm/yy	dd/mm/yy

Purpose	DCO APPLICATION
PINS Reference Number	TR010062/APP/5.17

Client	3 Piccadilly Place Manchester M1 3BN	
--------	--------------------------------------------	--

Project Name / Scheme Name
**A66 Northern Trans-Pennine Project
 Scheme 0102
 M6 Junction 40 to Kemplay Bank**

Drawing Title
**Engineering Section Drawings
 (Plan and Profiles)
 Regulation 5(2)(o) & 6(2)
 Sheet 5 of 6**

Project Ref. No.	Stage	Scale:	@ A1
---	PCF3	1:2500	
		Dimensions:	M

Drawing Number	Project	Originator	Volume
HE565627	- AMY	- HAC	-
S0102	-DR-CH-	101002	
Location	Type	Role	Number

Suitability	Suitability Description	Revision
A	Approved for Stage Complete	C01

NOTE:
 FOR PLAN VIEW OF KEMPLAY
 PLEASE REFER TO DRAWING
 SHEET 2 OF 6

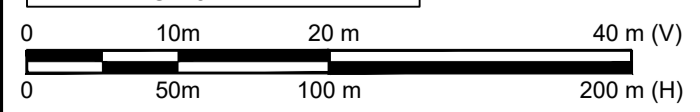

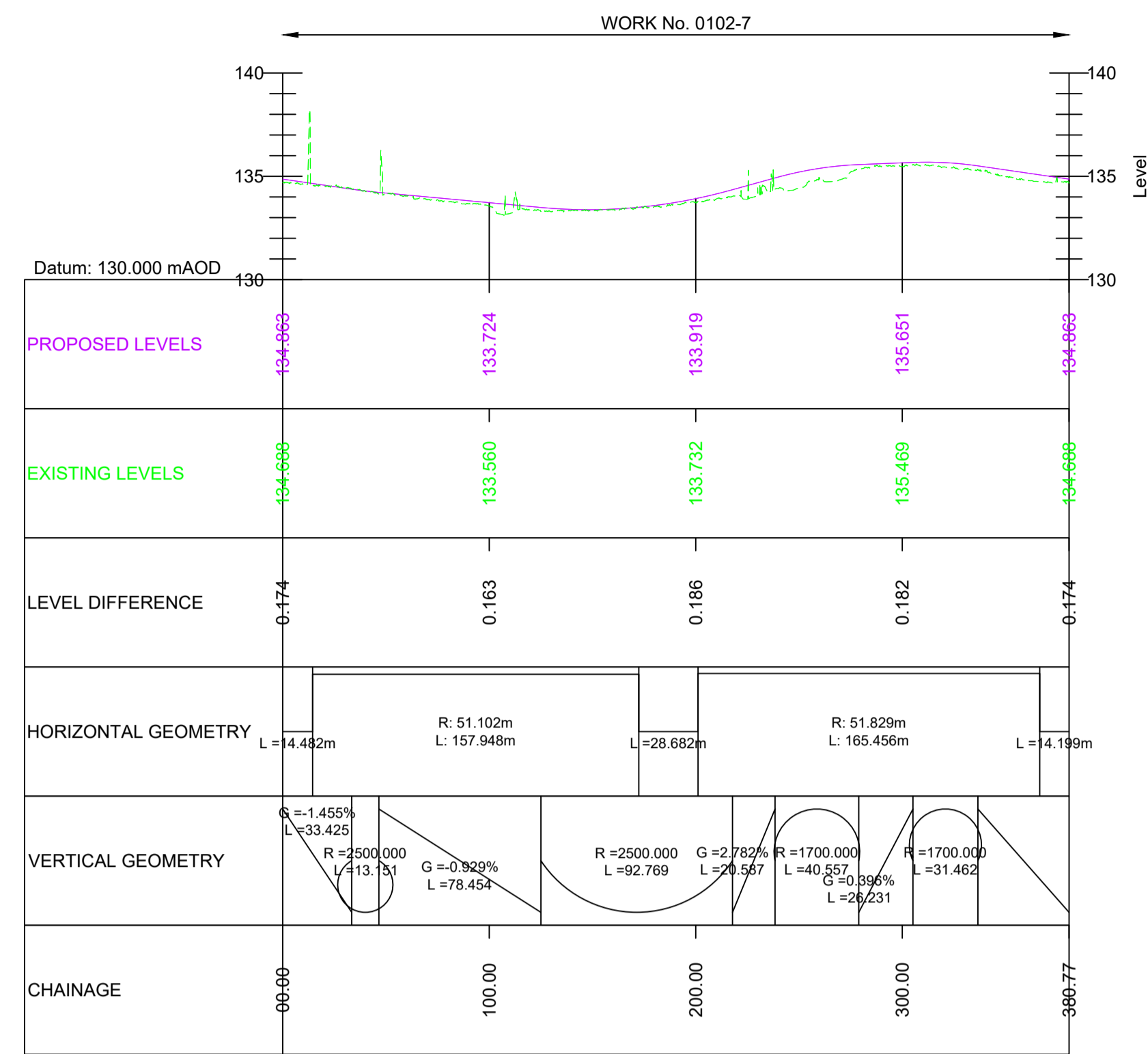

Scale H 1:2500; V 1:1250

KEMPLAY BANK ROUNDABOUT

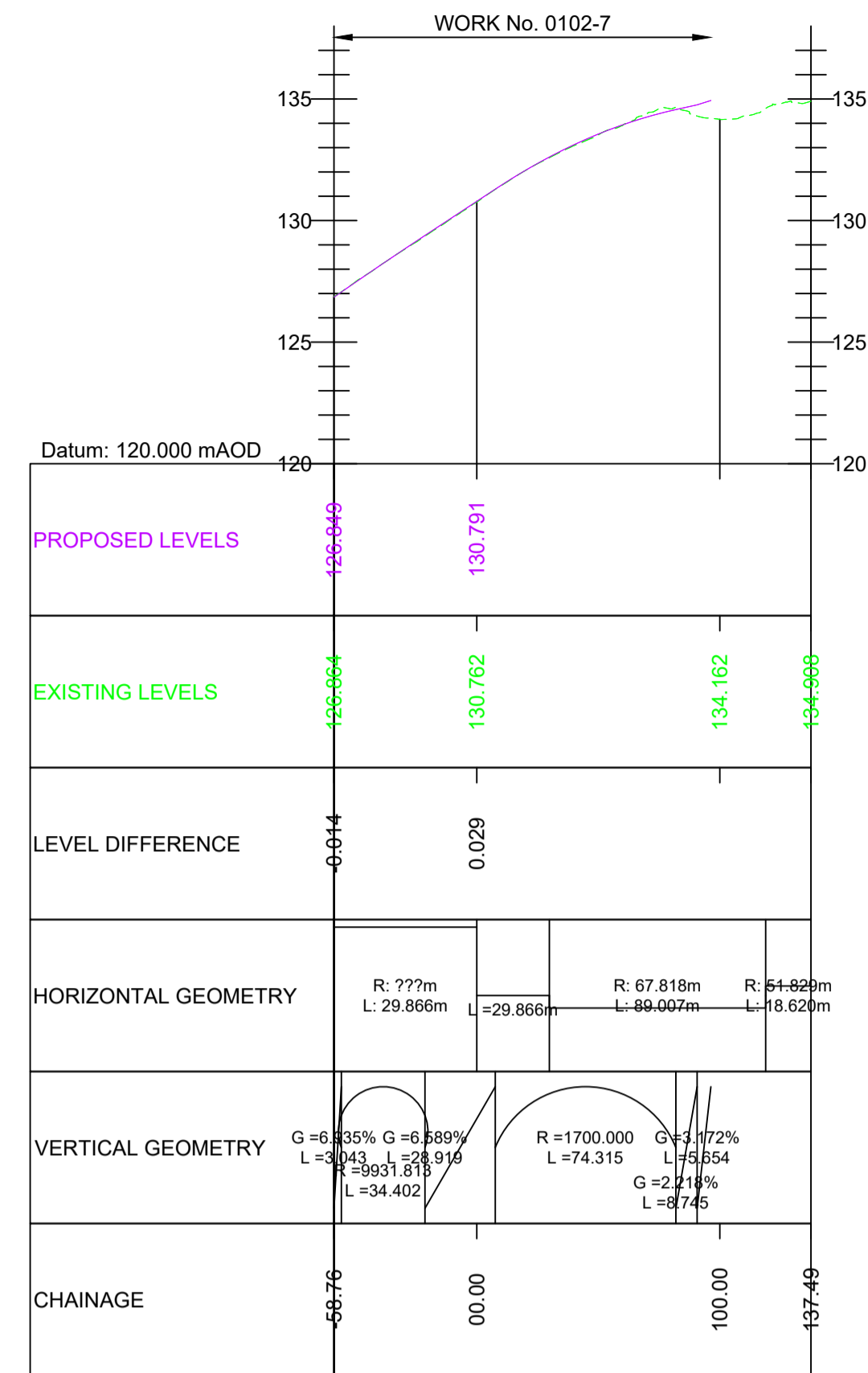

Scale H 1:2500; V 1:1250

A6 NORTHBOUND TO KEMPLAY BANK ROUNDABOUT

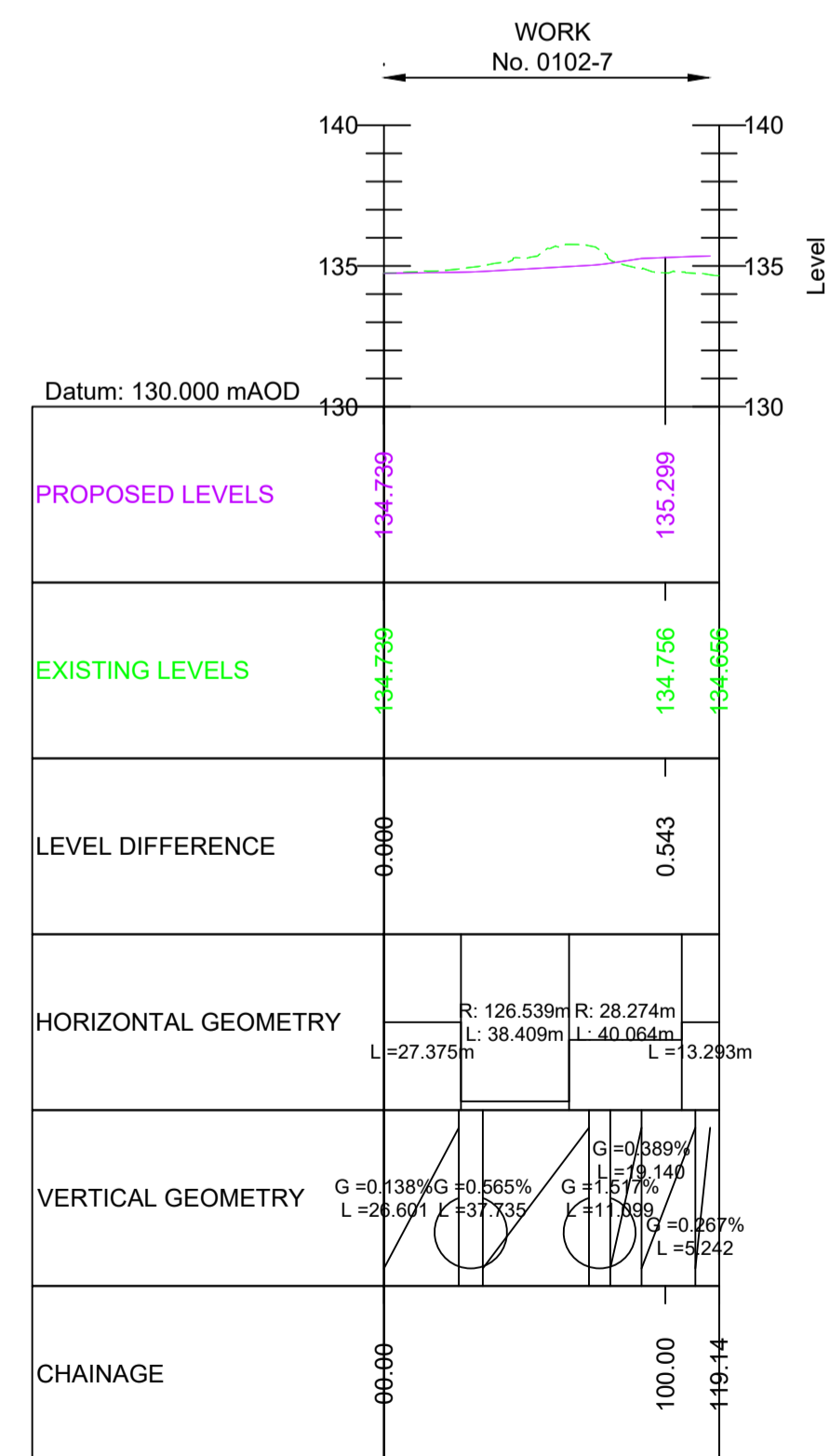

Scale H 1:2500; V 1:1250

A6 SOUTHBOUND TO KEMPLAY BANK ROUNDABOUT

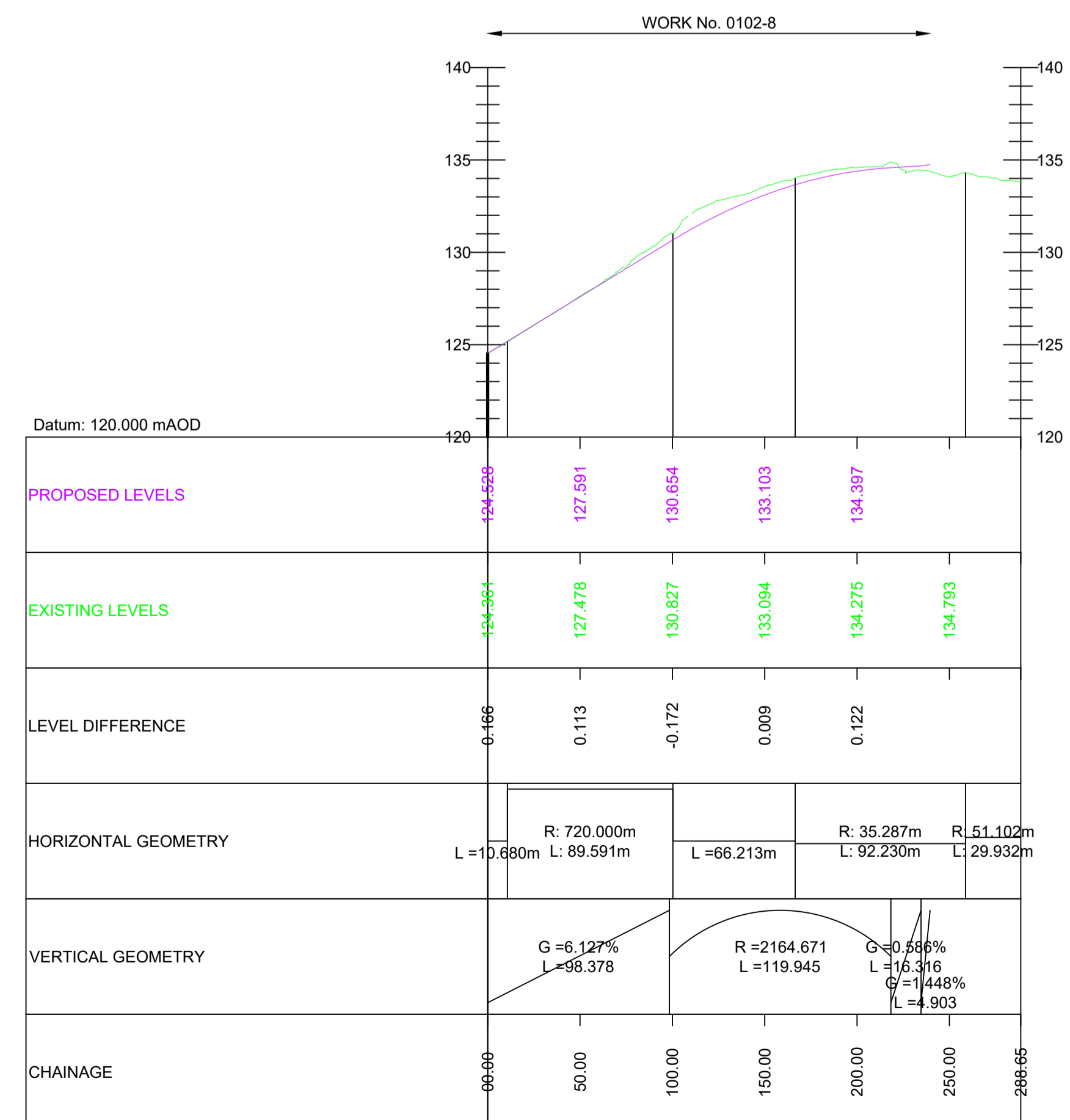

Scale H 1:2500; V 1:1250

A686 SOUTHBOUND TO KEMPLAY BANK ROUNDABOUT

NOTES

- ALL DIMENSIONS ARE IN METRES ABOVE DATUM UNLESS NOTED OTHERWISE.
- THESE ENGINEERING SECTION DRAWINGS SHOULD BE READ IN CONJUNCTION WITH THE KEY PLAN AND ALONGSIDE OTHER PLANS AND DOCUMENTS IN THE DEVELOPMENT CONSENT ORDER APPLICATION. IN PARTICULAR THE WORKS PLANS AND SCHEDULE 1 (AUTHORISED DEVELOPMENT) TO THE DEVELOPMENT CONSENT ORDER.
- WORK No. REFERENCES ARE DETAILED IN SCHEDULE 1 (AUTHORISED DEVELOPMENT) TO THE DEVELOPMENT CONSENT ORDER.
- THE DESIGN SHOWN ON THESE ENGINEERING SECTION DRAWINGS IS ILLUSTRATIVE AND WILL BE SUBJECT TO DETAILED DESIGN DEVELOPMENT; ANY CHANGES WILL BE LIMITED TO BEING WITHIN THE ORDER LIMITS AND ANY OTHER CONSTRAINTS INCLUDED IN THE DEVELOPMENT CONSENT ORDER.

KEY

- PROPOSED LEVEL
- SURVEY LEVEL
- G = Gradient
- L = Length
- R = Radius

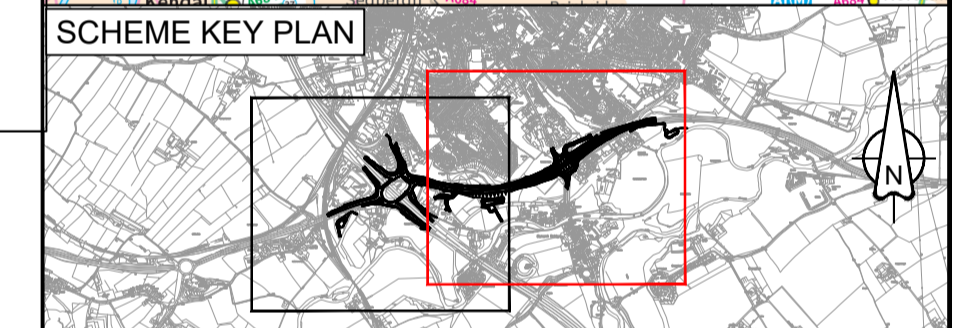
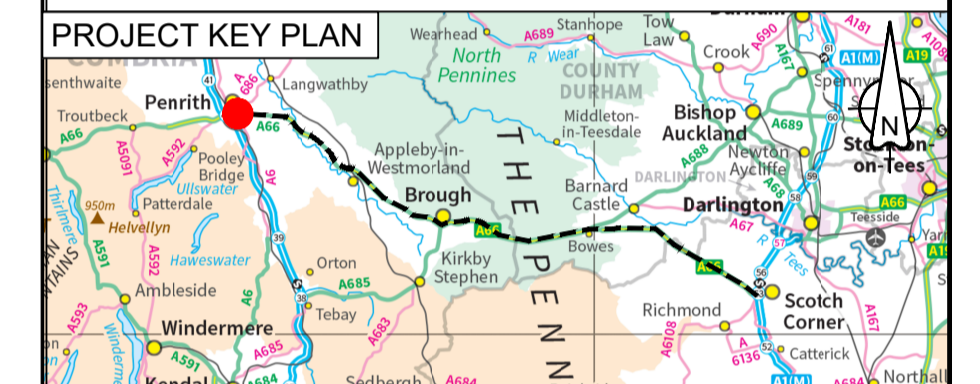

C01	For DCO Submission				
	ESWA	FBLA	ASCR	SBAG	SBAG
	01/06/22	01/06/22	06/06/22	06/06/22	06/06/22
Revision	Revision details				
	Created	Checked	Reviewed	Approved	Authorised
	dd/mm/yy	dd/mm/yy	dd/mm/yy	dd/mm/yy	dd/mm/yy

Purpose	DCO APPLICATION
PINS Reference Number	TR010062/APP/5.17

Client	3 Piccadilly Place Manchester M1 3BN	
--------	--------------------------------------------	--

Project Name / Scheme Name	A66 Northern Trans-Pennine Project Scheme 0102 M6 Junction 40 to Kemplay Bank
Drawing Title	Engineering Section Drawings (Plan and Profiles) Regulation 5(2)(o) & 6(2) Sheet 6 of 6

Project Ref. No.	Stage	Scale:	@ A1
---	PCF3	1:2500	
		Dimensions:	M

Drawing Number	Project	Originator	Volume
HE565627 - AMY - HAC -			
S0102	-DR-CH-	101004	
Location	Type	Role	Number

Suitability	Suitability Description	Revision
A	Approved for Stage Complete	C01

NOTE:
FOR PLAN VIEW OF KEMPLAY
PLEASE REFER TO DRAWING
SHEET 2 OF 6

